



# Periwinkle Inn

## • 2010 Daily Rate Schedule

www.periwinkleinn.com  
Email: info@periwinkleinn.com

1039 Beach Avenue, PO Box 220  
Cape May, NJ 08204

609.884.9200

### WELCOME TO THE PERIWINKLE INN, AN OCEANFRONT INN...

Where you can relax and enjoy poolside accommodations with warm hospitality and direct access to the beach and promenade.

At the Periwinkle Inn, we strive to fulfill and cater to your every need. We offer the comforts of home, including...

- Free Internet Access
- Complimentary In-Room Coffee
  - Microwaves
  - Refrigerators
  - Color Televisions
- Individual Heat or Air Conditioning
  - Private Balconies or Patios
  - Elevator
  - Hair Dryers
  - Personal Bath Amenities
- Free Local Telephone Calls
- Daily Housekeeping Service
- All Non-Smoking Rooms
  - On-Site Parking

Our lovely landscaped pool area with barbecues, shuffleboard courts, doll house and sand box will bring lasting memories for years.

The Periwinkle Inn is located within walking distance from the historic district, local restaurants, shopping, sightseeing, golf and all that Cape May has to offer.

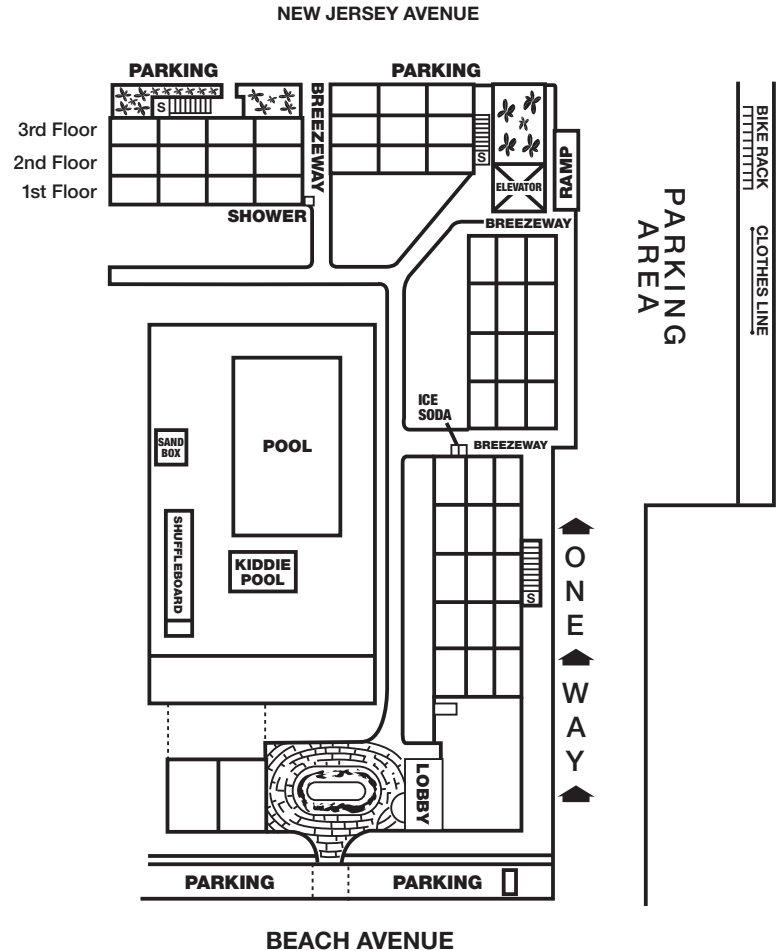

## Important Information

Check In: BETWEEN 3pm and 8pm  
 Confirmed reservations held ONLY until 8pm  
 If arriving later, special arrangements MUST be made  
 Departure Time: By 11am  
 Lobby Hours: 9am - 10pm  
 Sorry, NO PETS  
 One vehicle per unit  
 Special requests are noted but not guaranteed

## Deposit & Cancellation Policies

- A deposit is required WITHIN 7 DAYS of making reservations to avoid cancellation
- A confirmation will be sent UPON receipt of deposit, if time permits
- Deposits are NON-REFUNDABLE if notified less than 21 days prior to arrival date
- If eligible for refund, a 25% service fee will be applied
- Deposits are NOT transferable
- Guests are responsible for the TOTAL amount of nights reserved
- NO refunds for shortened stays

### \*\*\* UPON ARRIVAL\*\*\*

- Your balance is DUE IN FULL for number of nights reserved, payable in either CASH or TRAVELERS CHECKS only. Credit cards are not accepted in high season. Personal checks are NOT accepted upon arrival.

**RESERVE EARLY TO ENSURE AVAILABILITY**



# Periwinkle Inn

## • 2010 Daily Rate Schedule

www.periwinkleinn.com  
 Email: info@periwinkleinn.com

1039 Beach Avenue, PO Box 220  
 Cape May, NJ 08204

609.884.9200

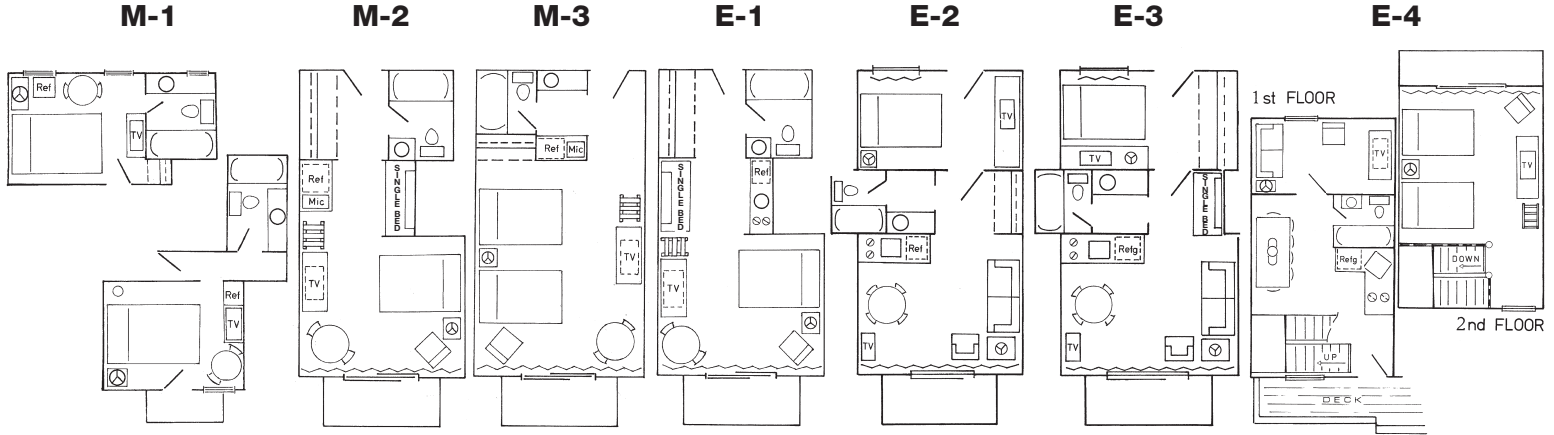

* RATES QUOTED FOR 1 OR 2 PERSONS					DELUXE 2 - ROOM SUITE		BI-LEVEL SUITE
STYLE OF ROOMS	M-1	M-2	M-3	E-1	E-2	E-3	E-4
<b>SLEEPING FACILITIES</b>	QUEEN BED	QUEEN BED SINGLE BED	2 QUEEN BEDS	KITCHENETTE QUEEN BED SINGLE BED	KITCHENETTE QUEEN SLEEP SOFA QUEEN BED 2 TV'S	KITCHENETTE QUEEN SLEEP SOFA QUEEN BED SINGLE BED 2 TV'S	<b>1ST FLOOR:</b> KITCHENETTE QUEEN SLEEP SOFA <b>2ND FLOOR:</b> 2 QUEEN BEDS 2 TV'S
May 7 - May 20	\$79 - \$92	\$96	\$99	\$106	\$112	\$118	\$125
May 21 - June 3	\$105 - \$115	\$120	\$128	\$150	\$155	\$161	\$175
June 4 - June 17	\$120 - \$139	\$154	\$160	\$167	\$171	\$179	\$205
June 18 - July 1	\$151 - \$174	\$184	\$192	\$209	\$212	\$221	\$265
July 2 - July 15	\$169 - \$201	\$212	\$218	\$235	\$246	\$253	\$324
July 16 - Sept. 5	\$209 - \$226	\$240	\$244	\$276	\$283	\$307	\$369
Labor Day - Sept. 18	\$125 - \$148	\$159	\$164	\$172	\$176	\$183	\$228
Sept. 19 - Oct. 16	\$95 - \$105	\$112	\$116	\$118	\$123	\$128	\$144
<b>OCTOBER 17TH - CLOSED FOR THE SEASON</b>							

### SPECIALS

- 5 Night Package - Pay regular rate for 4 nights - 5th night FREE
- 4 Night Package - Pay regular rate for 3 nights - 4th night \$40
- 3 Night Package - Pay regular rate for 2 nights - 3rd night \$50

#### Terms & Conditions

- Specials are available mid-week based on season & availability
- Please inquire about available weeks for specials
- Not available in high season

### MISCELLANEOUS CHARGES

- Rates subject to change without notice except for confirmed reservations
- Minimum stay required when applicable
- Each additional person - \$20 for adults, \$15 for children under 12 years old and children under 12 months FREE
- Additional charge for weekends and holidays
- Cots and cribs available for rent
- Rates do not include taxes
- Special request fees may apply